

**BX.1 TYPICAL TACTILE PAVING & DROP KERB DETAILS
(AT INSET UNCONTROLLED CROSSING)**

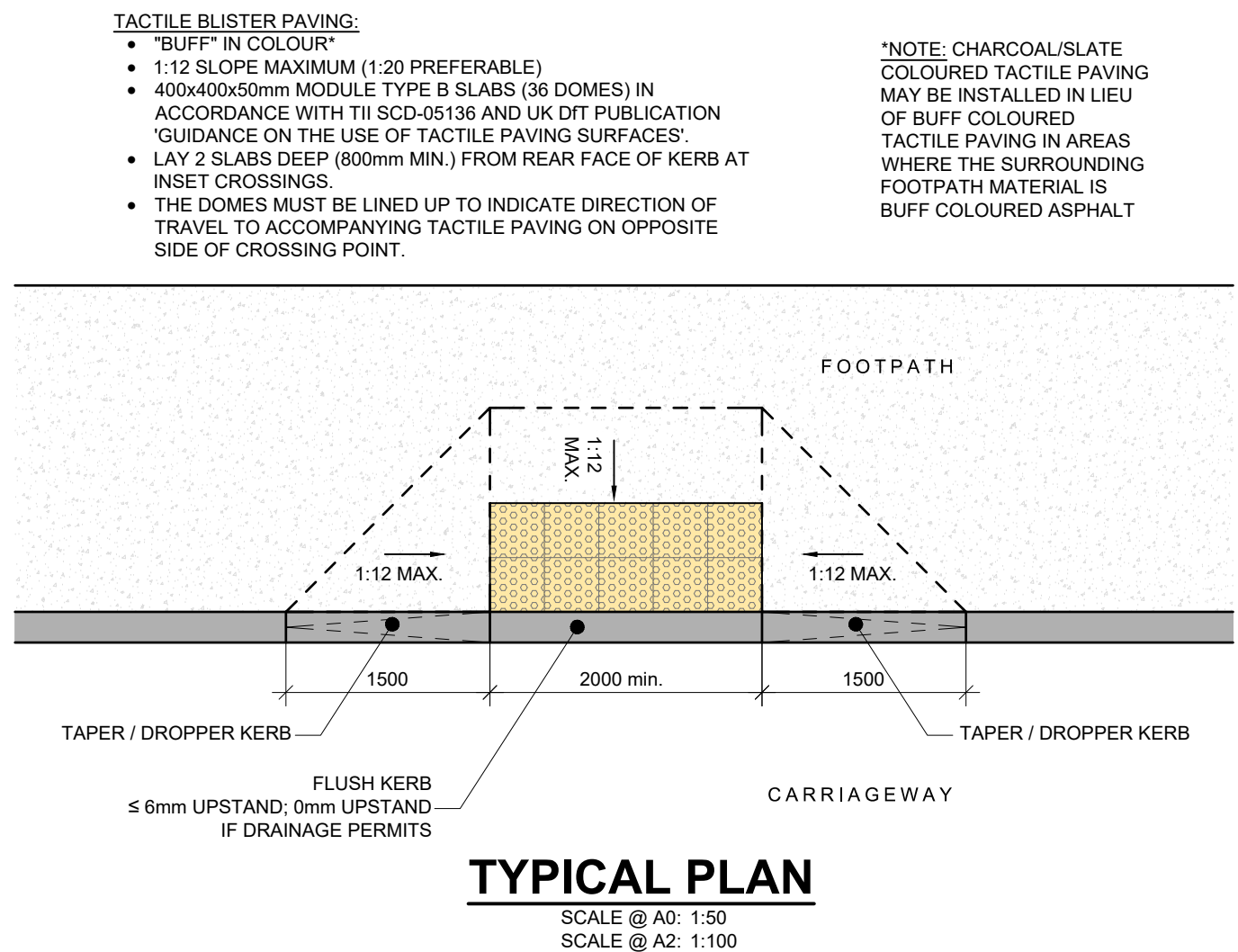

TYPICAL PLAN
SCALE @ A0: 1:50
SCALE @ A2: 1:100

**BX.2 TYPICAL TACTILE PAVING & DROP KERB DETAILS
(AT INLINE UNCONTROLLED CROSSING)**

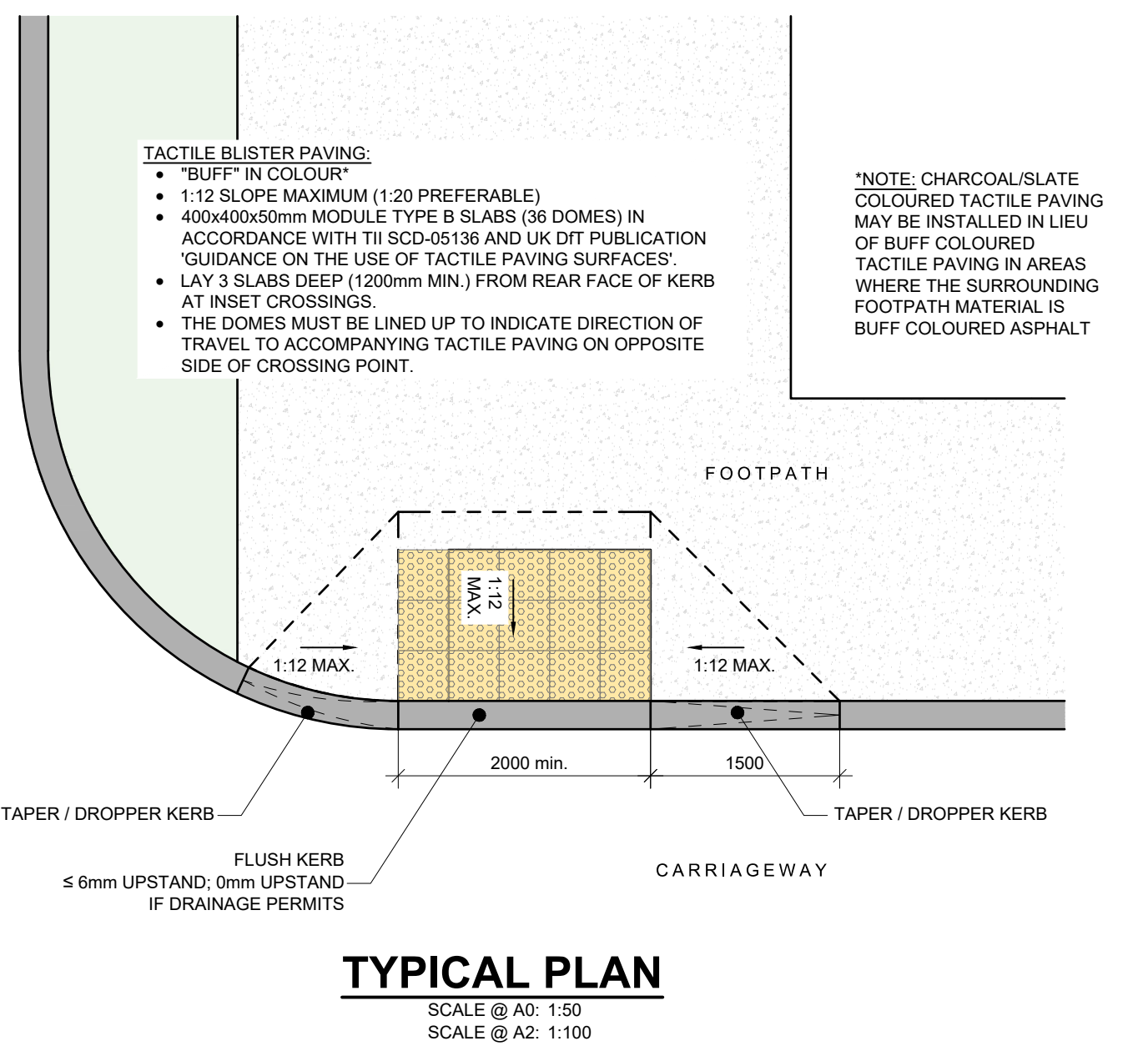

TYPICAL PLAN
SCALE @ A0: 1:50
SCALE @ A2: 1:100

**BX.3 TYPICAL TACTILE PAVING AT SIGNAL CONTROLLED
OR ZEBRA CROSSING**

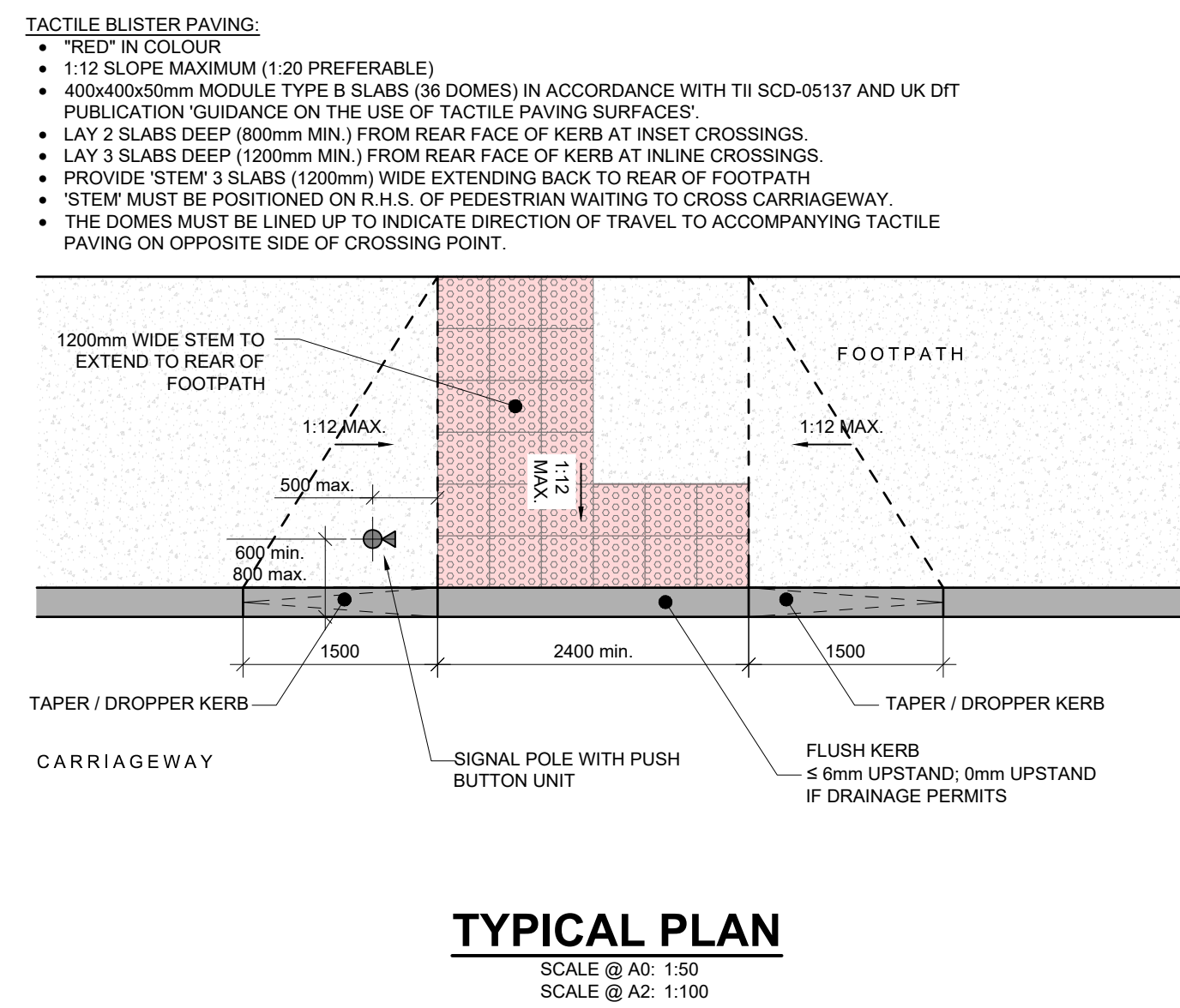

TYPICAL PLAN
SCALE @ A0: 1:50
SCALE @ A2: 1:100

BX.4 TYPICAL DROPPED KERB GEOMETRY

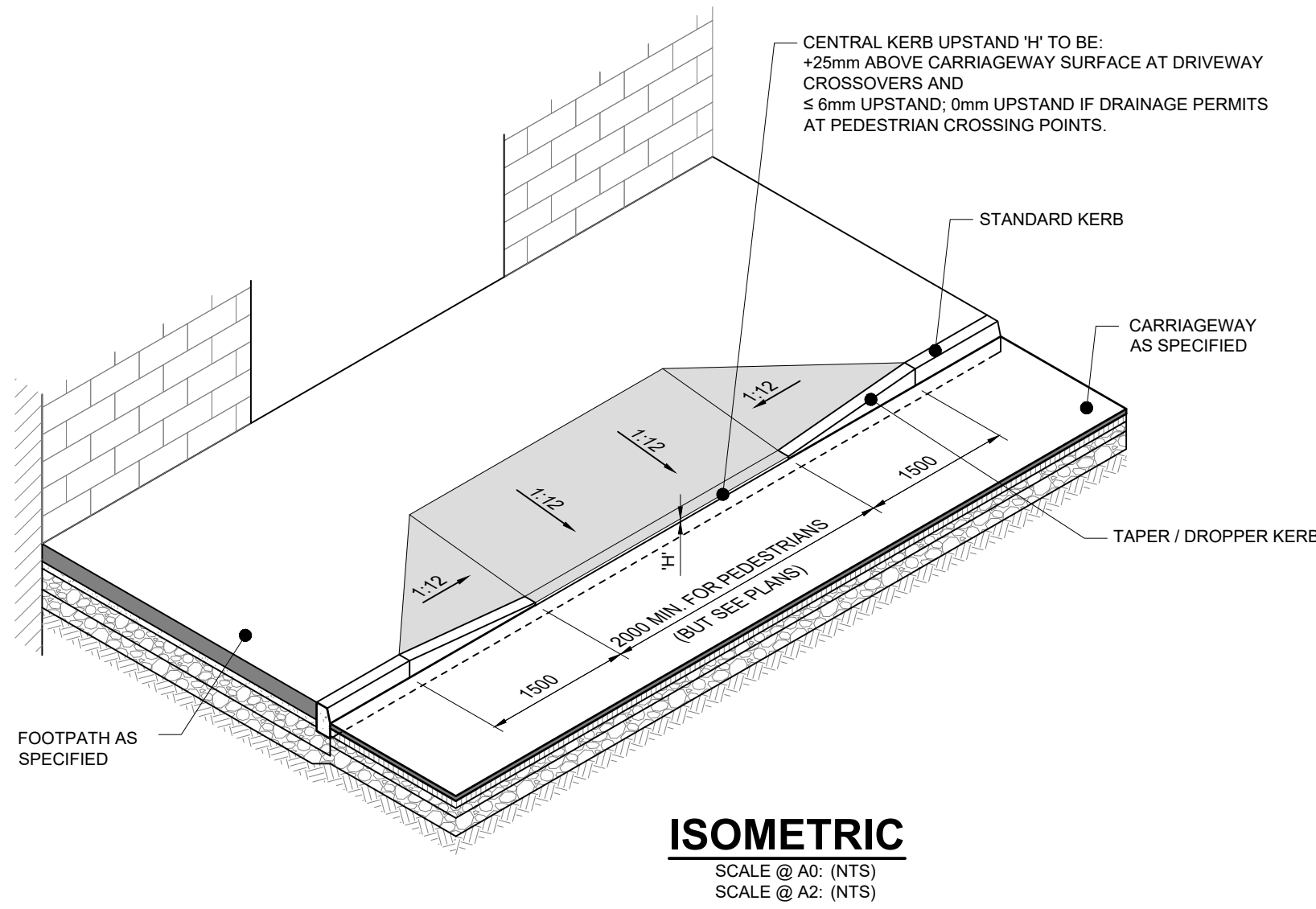

ISOMETRIC
SCALE @ A0: (NTS)
SCALE @ A2: (NTS)

BX.5 TACTILE PAVING SLAB DIMENSIONS

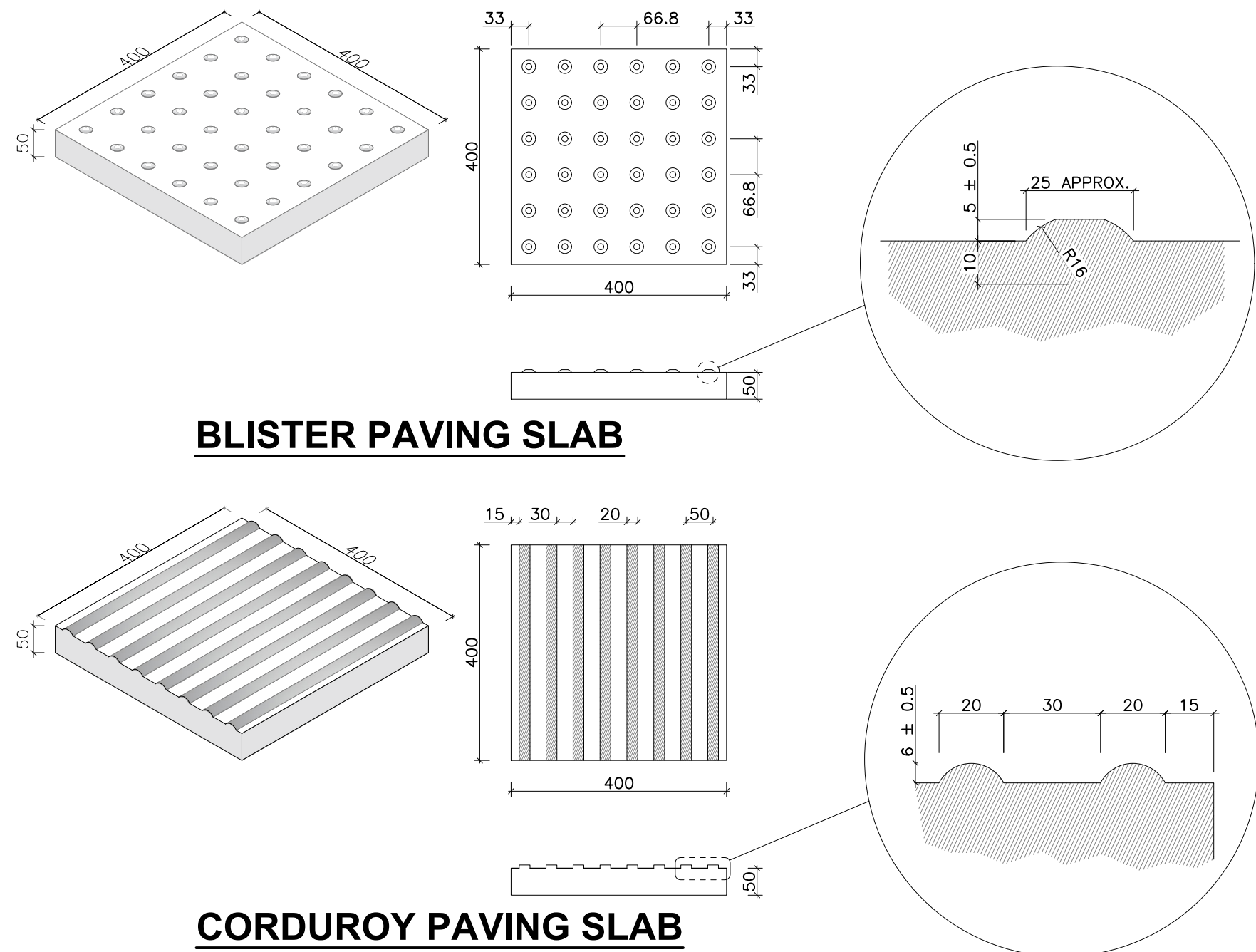

BLISTER PAVING SLAB

CORDUROY PAVING SLAB

**BX.6 TYPICAL TACTILE PAVING AT AN UNCONTROLLED
CROSSING ON A KERB TO KERB FLAT TOP RAISED
CROSSING (AWAY FROM JUNCTION)**

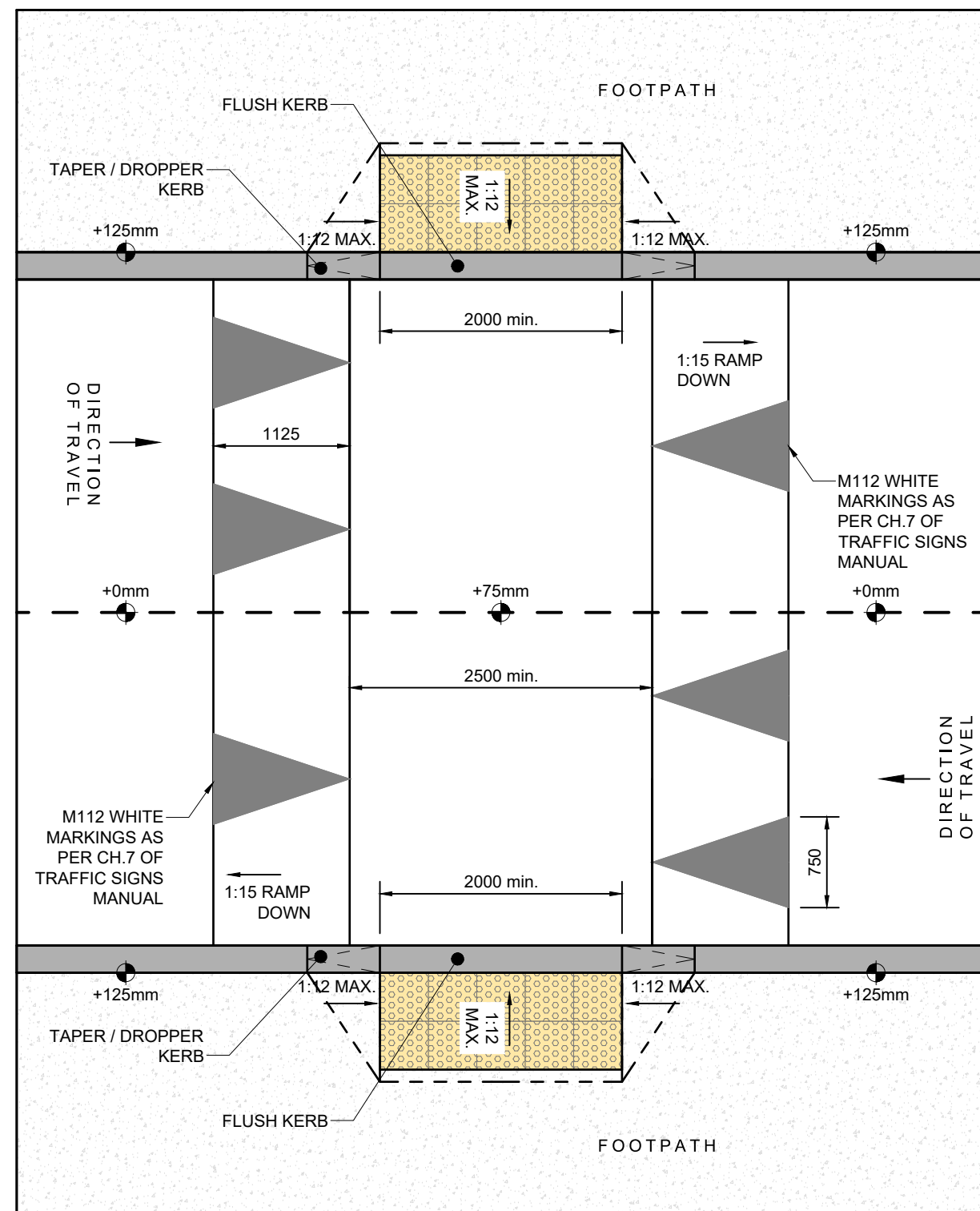

TYPICAL ARRANGEMENT
SCALE @ A0: 1:50
SCALE @ A2: 1:100

BX.7 SECTION THROUGH RAISED FLAT TOP PEDESTRIAN CROSSING

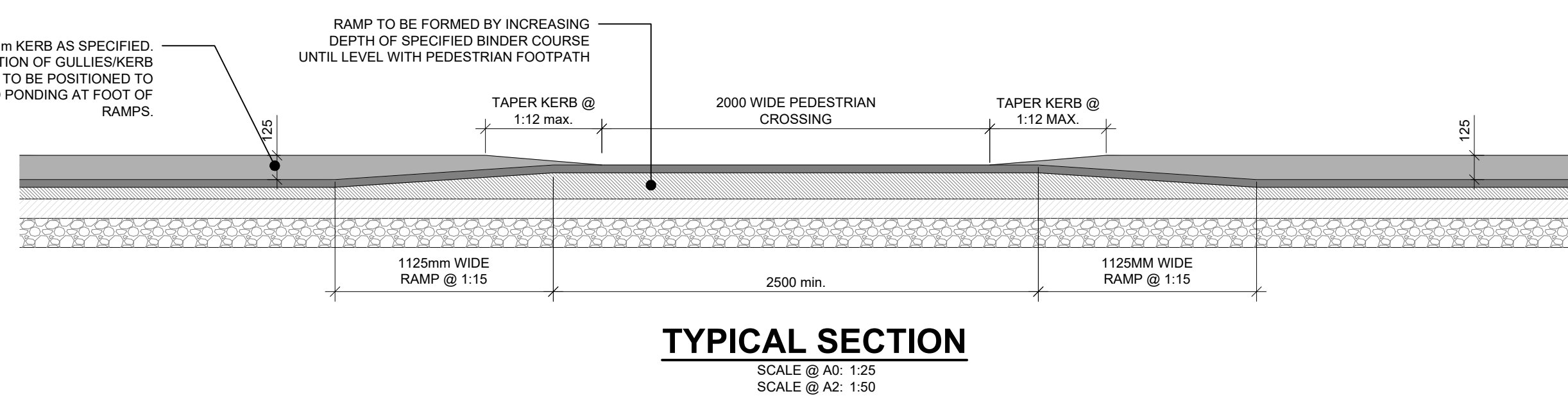

TYPICAL SECTION
SCALE @ A0: 1:25
SCALE @ A2: 1:50

BX.9 TYPICAL RAISED PEDESTRIAN PRIORITY ENTRY TREATMENT

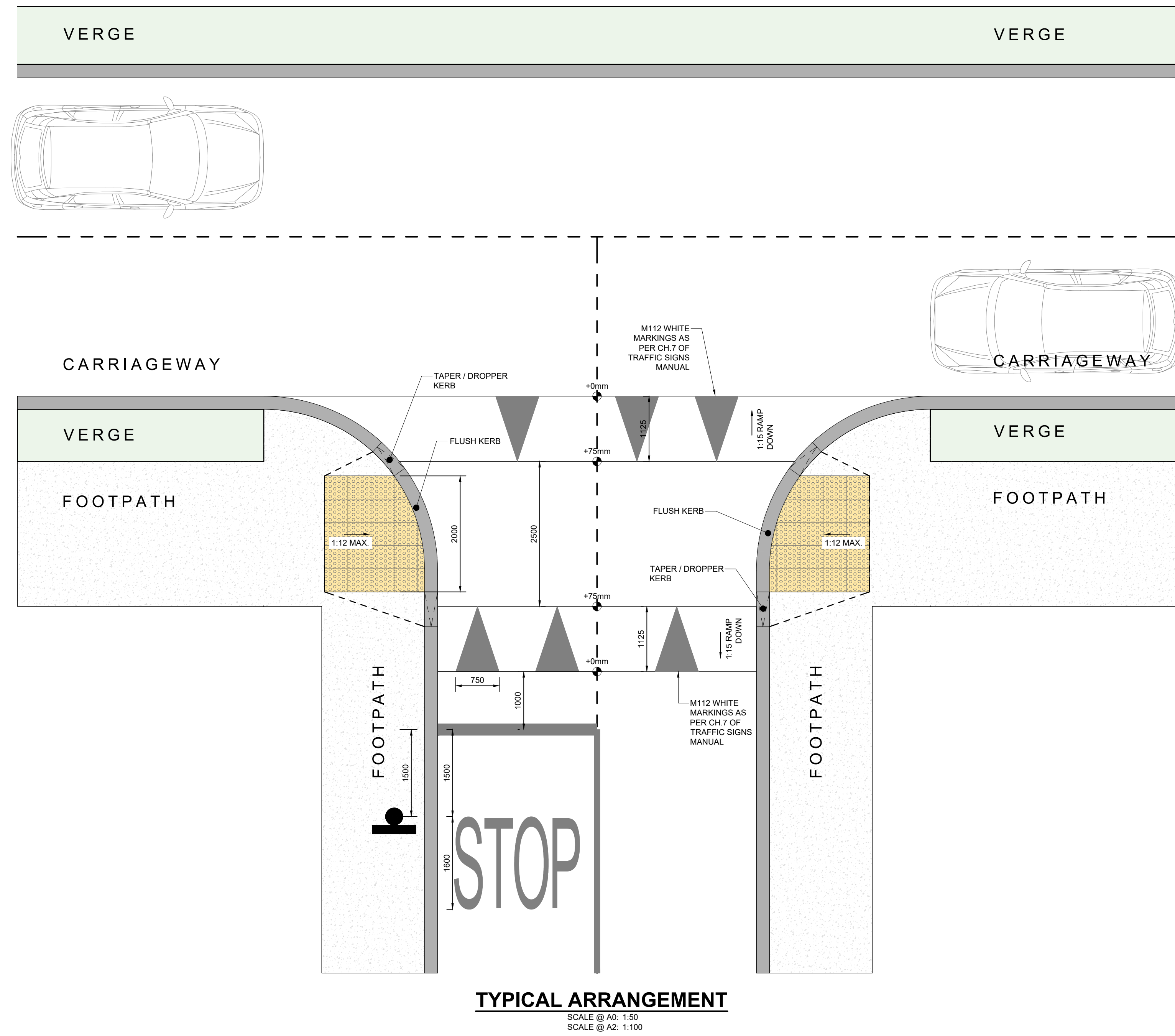

TYPICAL ARRANGEMENT
SCALE @ A0: 1:50
SCALE @ A2: 1:100

BX.10 TYPICAL SERVICES LAYOUT IN FOOTPATHS

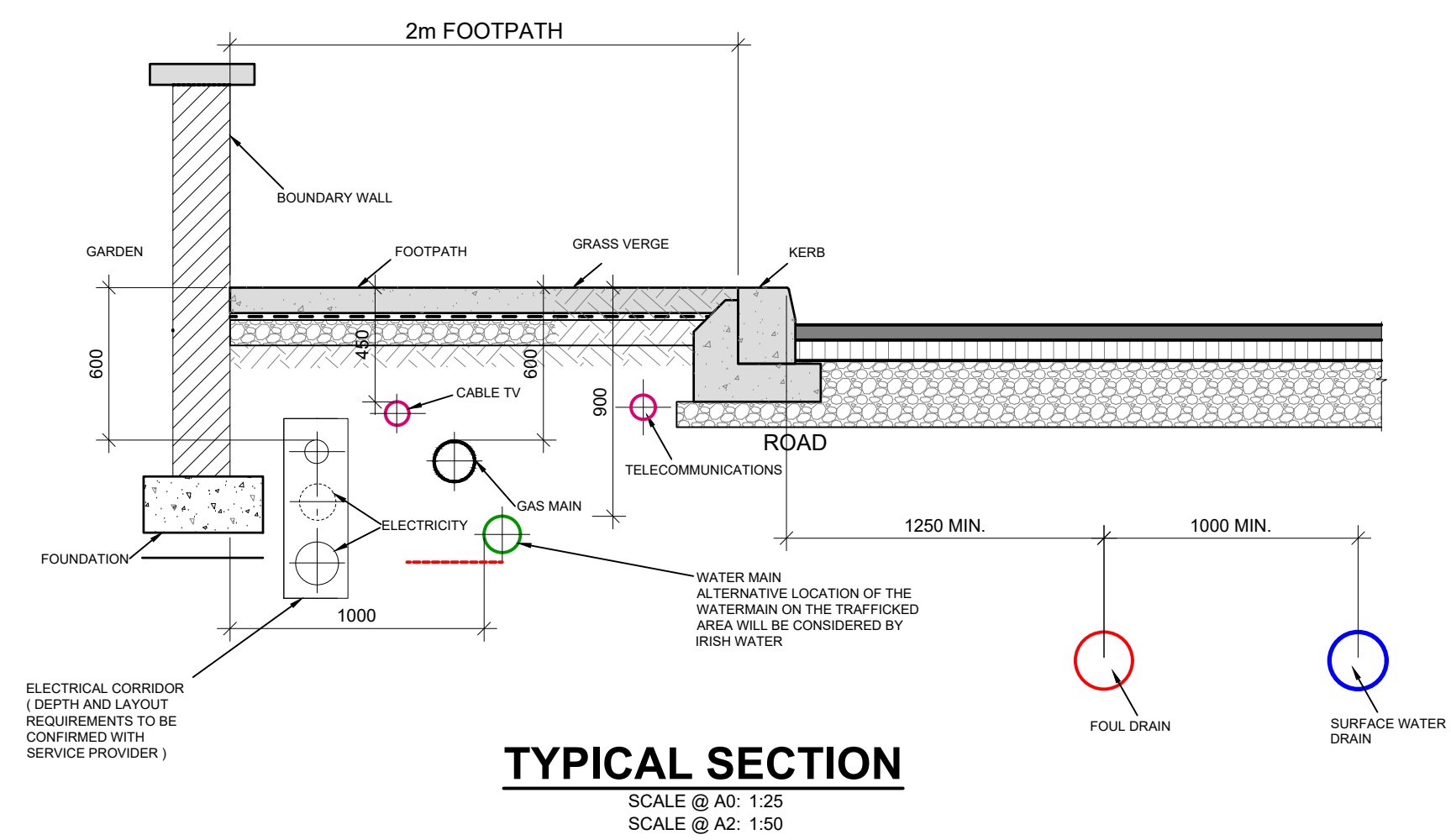

TYPICAL SECTION
SCALE @ A0: 1:25
SCALE @ A2: 1:50

TYPICAL SERVICES LAYOUT

NOTES

1. THIS DRAWING IS TO BE READ IN CONJUNCTION WITH ALL ENGINEERS & ARCHITECTS DRAWINGS FIGURED DIMENSIONS ONLY (NOT SCALING) TO BE USED WHERE A CONFLICT OF INFORMATION EXISTS OR IF IN ANY DOUBT - ASK
2. CONSULTANTS TO BE INFORMED IMMEDIATELY OF ANY DISCREPANCIES BEFORE WORK PROCEEDS.

PL2	10.05.25	ISSUED FOR PLANNING	MA
PL1	22.07.24	ISSUED FOR PLANNING	MA
ISSUE	DATE	DESCRIPTION	BY

Project Engineer: BD Project Director: CK

BM STAGE

PLANNING

BM
Barrett Mahony
Consulting Engineers, Civil, Structural, Project Management & Environmental
Dublin Office:
Sandwell House, 52-54 Lower Sandwell Street, Dublin 2, Ireland.
Tel: 01 677 3500 Fax: 01 677 3166
London Office:
5th Floor, Mail House, 8 MM Street, London EC1M 2BA, United Kingdom
Tel: (0044) 20 3750 3530



CLIENT
GOLDEN PORT HOMES LIMITED

PROJECT TITLE
**FOREST LITTLE ROAD
GOLDENPORT**

PROJECT NO.
24.183

REFERENCE
1

SUITABILITY
1

REVISION
1

DRAWING TITLE
FOOTPATH STANDARD DETAILS - SHEET 2

DRAWING REFERENCE
FR-BMOE-ZZ-ZZ-DR-C-12111

STATUS
PL2